

Raccordi Femmina Filetto metrico Sede 24° con O-Ring per tubi: DIN 20023-4SH EN 856-4SH SAE 100R13 EN 856-R13 SAE 100R15
 Metric Females 24° Cone with O-Ring for Hoses: DIN 20023-4SH EN 856-4SH SAE 100R13 EN 856-R13 SAE 100R15
 Metrisch 24° Dichtkegel mit O-Ring für Schläuche: DIN 20023-4SH EN 856-4SH SAE 100R13 EN 856-R13 SAE 100R15

ISO 12151-2 (ISO 8434-1)

MDKOS

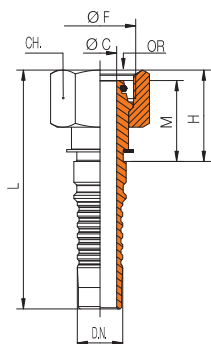

CODICE Part n° Bestell. nr.	DN ND DN	Filetto Thread Gewinde	Ø F ø F ø F	DN Tubo ND Hose DN Schlauch	CH	L	Ø C	H	M	OR
b S 80 41 0 920 019	20S	M 30x2	3/4"	19	36	102	14	40	34	16x2,5
b S 80 41 0 925 019	25S	M 36x2	3/4"	19	46	105,5	14	43,5	37	20x2,5
b S 80 41 0 930 025	30S	M 42x2	1"	25	50	120	19	46	39	25x2,5
b S 80 41 0 938 032	38S	M 52x2	1 1/4"	32	60	134,5	25	54,5	44,5	33x2,5

MDKOS 90

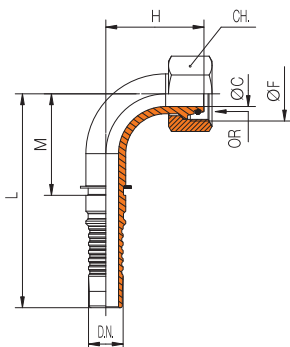

b S 80 53 0 920 019	20S	M 30x2	3/4"	19	36	125,5	14	57,5	63,5	16x2,5
b S 80 53 0 925 019	25S	M 36x2	3/4"	19	46	125,5	14	62	63,5	20x2,5
b S 80 53 0 930 025	30S	M 42x2	1"	25	50	157,5	19	72,5	83,5	25x2,5
b S 80 53 0 938 032	38S	M 52x2	1 1/4"	32	60	182	25	91	102	33x2,5

MDKOS 45

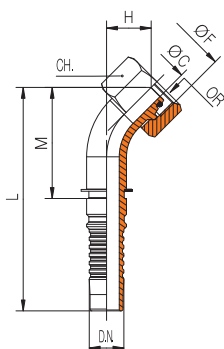

b S 80 83 0 920 019	20S	M 30x2	3/4"	19	36	133	14	27	71	16x2,5
b S 80 83 0 925 019	25S	M 36x2	3/4"	19	46	136	14	30	74	20x2,5
b S 80 83 0 930 025	30S	M 42x2	1"	25	50	164	19	34,5	90	25x2,5
b S 80 83 0 938 032	38S	M 52x2	1 1/4"	32	60	192,5	25	41	112,5	33x2,5

b: dado passante

b: slip-on nut

b: Hinterschub-Überwurfmutter